

AUTOMATIC DRAIN VALVE SYSTEMS

Preassembled systems consisting of solenoid valve, timer and connector for time adjusted condensate discharge of tanks with compressed air, dryers and filters.

TECHNICAL SPECIFICATIONS

Media: water, oil, air, inert gases

Media temperature: -10°C ... +130°C

Ambient temperature: -10°C ... +50°C

Seal material: FKM

Coil power: AC 18VA (holding)

AC 36VA (inrush)

DC 14W

Protection class: IP 65 (with connector)

Discharge (ON) time: 0,5 to 10 sec;

Interval time: 30 sec to 45 min;

Test switch: manual

OPTIONS

UL approval

Valve available with NPT thread (Ex code D248DVFN)

For additional components specifications see

Solenoid Valves Catalogue:

page 07 (Valves types D264 ÷ 266),

page 13 (Valves types D248/249);

page 37 (Connectors) and page 38 (Timer);



SELECTION TABLE	ASSEMBLY	solenoid valve	valve connection	valve nominal Ø	flow rate kv	OPD		supply	
	code	(code)	G	(mm)	(l/min)	min	max	(Volts/Hz)	
						(bar)	AC	DC	
WITH DIRECT ACTING SOLENOID VALVES									
	888 117 000	D248DVF	1/8"	2.2	2.4	0	18		110/50 - 120/60
	888 118 000					0	18		230/50 - 240/60
	888 119 000					0		16	24/DC
	888 120 000	D249DVF	1/4"	2.2	2.4	0	18		110/50 - 120/60
	888 121 000					0	18		230/50 - 240/60
	888 122 000					0		16	24/DC
WITH PILOT OPERATED SOLENOID VALVES									
	888 123 000	D264DVU	1/4"	10.5	21	0.1	16		110/50 - 120/60
	888 124 000					0.1	16		230/50 - 240/60
	888 125 000					0.1		7	24/DC
	888 126 000	D265DVU	3/8"	10.5	24	0.1	16		110/50 - 120/60
	888 127 000					0.1	16		230/50 - 240/60
	888 128 000					0.1		7	24/DC
	888 129 000	D266DVU	1/2"	10.5	25	0.1	16		110/50 - 120/60
	888 130 000					0.1	16		230/50 - 240/60
	888 131 000					0.1		7	24/DC

STRAINER FOR CONDENSATE DRAIN

Strainer consisting of a ball valve with filter to be used together with automatic drain valve. In order to clean and check the filter it is sufficient to close the valve to isolate it and then unscrew the plug.

TECHNICAL SPECIFICATIONS

Media: water, oil, air and inert gases

Media temperature: -10°C ... +130°C

Ambient temperature: -10°C ... +50°C

Body material: brass (EN 12165)

Ball valve material: chromed brass (EN 5705-65)

Filter material: stainless steel (AISI 304 UNIEN 10088-

Seal material: PTFE

Working pressure: 16 bar

Cap for inspection and cleaning

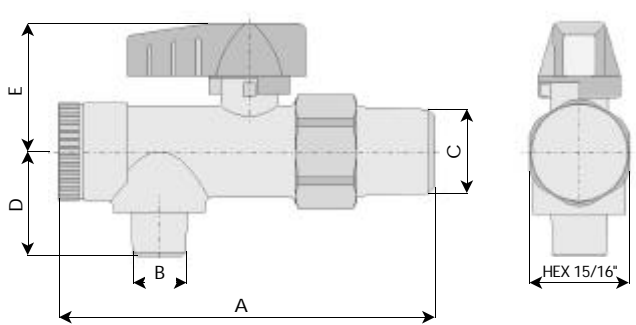
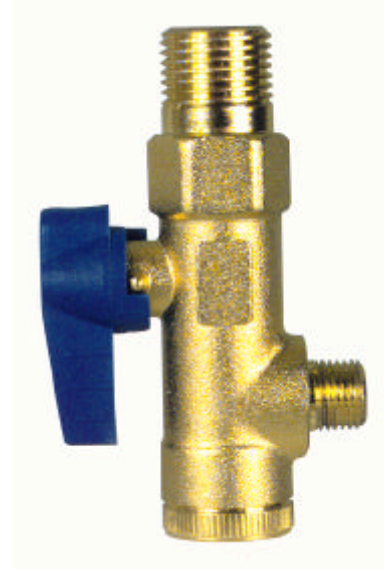

DIMENSIONS & WEIGHTS	STRAINERS	A	B	C	D	E	weight
	code	(mm)	(mm)	(mm)	(mm)	(mm)	(Kg)
	887 052 000	93	1/2" NPT	1/2" NPT	25.8	34.1	0.23
	887 053 000		3/8" NPT	1/2" NPT			
	887 054 000		1/4" NPT	1/2" NPT			
	887 057 000		G 1/2"	G 1/2"			
	887 058 000		G 3/8"	G 1/2"			
	887 059 000		G 1/4"	G 1/2"			
	887 060 000	153.5	1/4" NPT	7/8" UNF	25.8	34.1	0.41

AUTOMATIC DRAIN VALVE SYSTEM

Compressed air system must be engineered to allow condensate to collect at low points, where automatic drainage should be provided. Condensate is a mixture of: water, oil and dirt, its "thickness" or viscosity increasing with low temperatures. Operating drain valves manually is time consuming and costly, and those awkward positions often get forgotten.

The ADV overcomes all these problems allowing you to "tune" its operation, through the variable timers, to suit specific systems conditions.

Applications

- ! FILTERS
- ! SEPARATORS
- ! MAIN DRAINAGE
- ! DRYERS

TYPICAL INSTALLATION DIAGRAM

! automatic drain valve

1. air compressor
2. aftercooler unit
3. condensate separator
4. pre-filter
5. compressed air tank
6. intermediate filter
7. dryer
8. final filter

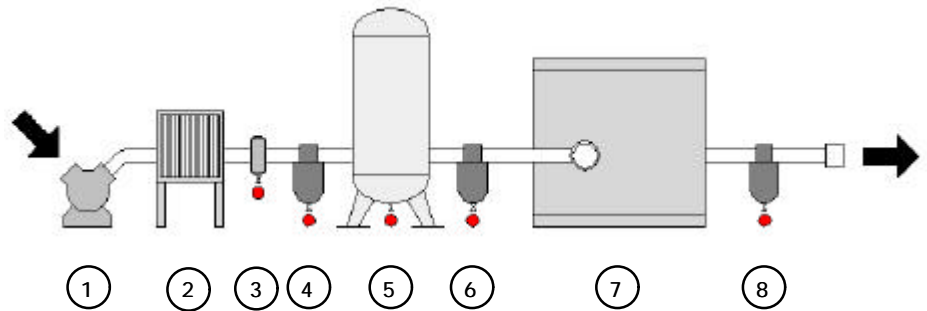

CHECK LIST

ON timer 0.5 / 10 seconds variable discharge time
OFF timer 0.5 / 45 minutes variable discharge frequency

IP65 enclosure

two solid state timers

low power consumption

LED on each timer

"test panel"

USER BENEFITS

variable to suit your system needs

indoor / outdoor installations

reliable, long life

easy on the pocket

visual indication of operation

manual override - test

The ADV drain unit can be used on air, oil, water and inert gases

worldwide solenoid valve producers

web site: www.mminternational.net e-mail: mm@mminternational.net